

Best Sanitizers, Inc. Installation & Operation Instructions

Model # SS20002 · BSI Pump Up Sprayer

REQUIREMENTS

RTU Chemical Solution

Temperature	up to 120°F
Pressure	up to 45 PSI

OPTIONS

Repair Kit

O Ring & Seal Repair Kit (Viton)	# 709040
O Ring & Seal Repair Kit (EPDM)	# 709040-E

Proportioning / Filling Options

BSI Push Lever Mixing Station	# MD20003
-------------------------------	-----------

WEIGHT & DIMENSIONS

Shipping Weight:	10 lbs.
Shipping Dimensions:	11" x 11" x 25"



www.bestsanitizers.com
888.225.3267

**WARNING! READ ALL
INSTRUCTIONS BEFORE
USING EQUIPMENT!**

OVERVIEW

The BSI Pump-Up Sprayer is a heavy-duty, portable spray applicator for applying ready-to-use chemicals on to any surface. This professional model features a more durable 6' hose, trigger gun, wand, and fan nozzle compared to your typical pump-up sprayer. Equipped with a compressed air "quick charge" valve to eliminate pumping if compressed air is available.

SAFETY & OPERATIONAL PRECAUTIONS

- Manufacturer assumes no liability for the use or misuse of this unit.
- Wear protective clothing, gloves and eye wear when working with chemicals.
- Always direct the discharge away from electrical devices and people/animals (as appropriate)
- Follow the chemical manufacturer's safe handling instructions.

SPECIAL PRECAUTIONS

- This high density polyethylene unit is fitted with Viton seals. Chemicals not compatible with polyethylene or Viton should not be used. (EPDM seals are available for separate purchase.)
- Do not alter pressure relief valve or plug valve hole.
- Regularly lubricate pressure relief valve with a non-water-soluble grease (such as petroleum jelly) and ensure proper operation, using water in the tank, prior to each use. Regular lubrication of cap seal and threads with a non-water-soluble grease (petroleum jelly) will help ensure proper sealing of cap.
- Do not lift or carry by the hose or trigger gun. Securely tighten pump: loose pump can be forcibly ejected.
- Carefully follow chemical manufacturer's safe handling instructions and recommended precautions/practices when using flammable chemicals. Do not use hot liquids.
- Do not exceed 45 psi pressure and do not inflate without liquid in the tank
- Do not fill over the maximum fill mark. Relieving pressure in an overfill condition can cause harmful venting of contents.
- Never stand with face or body over the top of tank when loosening pump or relieving pressure.
- After pumping, be sure the handle is in the locked down position
- On completion of operation, with the tank in the upright position, relieve pressure in the tank by pulling up on the pressure relief valve on the side of the tank.

WARNING

This unit is equipped with a built-in inflation valve and can be pressurized using an air compressor. Extra caution is required when using a compressor, as the unit will be pressurized much more rapidly than when hand-pumping. Failure to follow the following procedure could result in serious injury to the operator or others.

1. Before each use of a compressor be certain that:
 - a. The umbrella valve, located at the bottom of the cylinder, is installed and functioning properly.
 - b. The pump assembly is screwed tightly to the tank.
 - c. The pressure relief valve is functioning properly. Check by pulling up on the valve until the red stem shows. The valve stem should move freely and spring back to its original position when released. The O-ring and valve stem must be greased.
 - d. Check the hose clamp and tighten if loose.
2. Additional Precautions:
 - a. Do not stand over the pump handle while pressurizing with an air compressor or while releasing the handle from the locked position. Compressed air can cause the pump handle to pop up upward if the umbrella valve is worn or damaged or if the pressure relief valve is not functioning.

TO INSTALL (REFER TO DIAGRAM ON NEXT PAGE)

1. Turn pump handle counterclockwise to remove pump and lid.
2. Add chemical solution to the tank. DO NOT EXCEED MAXIMUM FILL MARK.
3. Tighten cap and pump for a good seal. Regular lubrication of cap seal and threads will help ensure proper sealing and removal of cap.

NOTE it is a good idea to thoroughly rinse out tank and re-pressurize and flush out entire nozzle assembly before storing. When using aggressive or corrosive chemicals never leave chemical solution in the tank after use.

TO OPERATE

1. Pump up sprayer till the pressure relief valve starts to rise/relieve. Less if a lighter spray pressure and volume is desired.
2. Pull the trigger to start and stop spraying. Re-pump up as spray begins to slow down.
3. On completion of spraying, with the tank in the upright position, **relieve pressure** in the tank by pulling up on the pressure relief valve on the side of the tank.
4. Prior to every refill of the tank pull up on relief valve to ensure no pressure is there before removing the lid and pump.
5. To store: Partially fill the tank with fresh water and pump it up. Pull the trigger and rinse the sprayer out.

WHEN USING AN AIR COMPRESSOR: Place pump handle in the unlocked position and pressurize slowly till the pop-off valve starts to rise. If the **pump handle** rises...DISCONTINUE PRESSURIZING! Relieve pressure by pulling up on the pressure relief valve, remove pump and check the umbrella valve for wear or damage. Do not pressurize until worn or damaged parts have been replaced and the handle does not rise during pressurization.

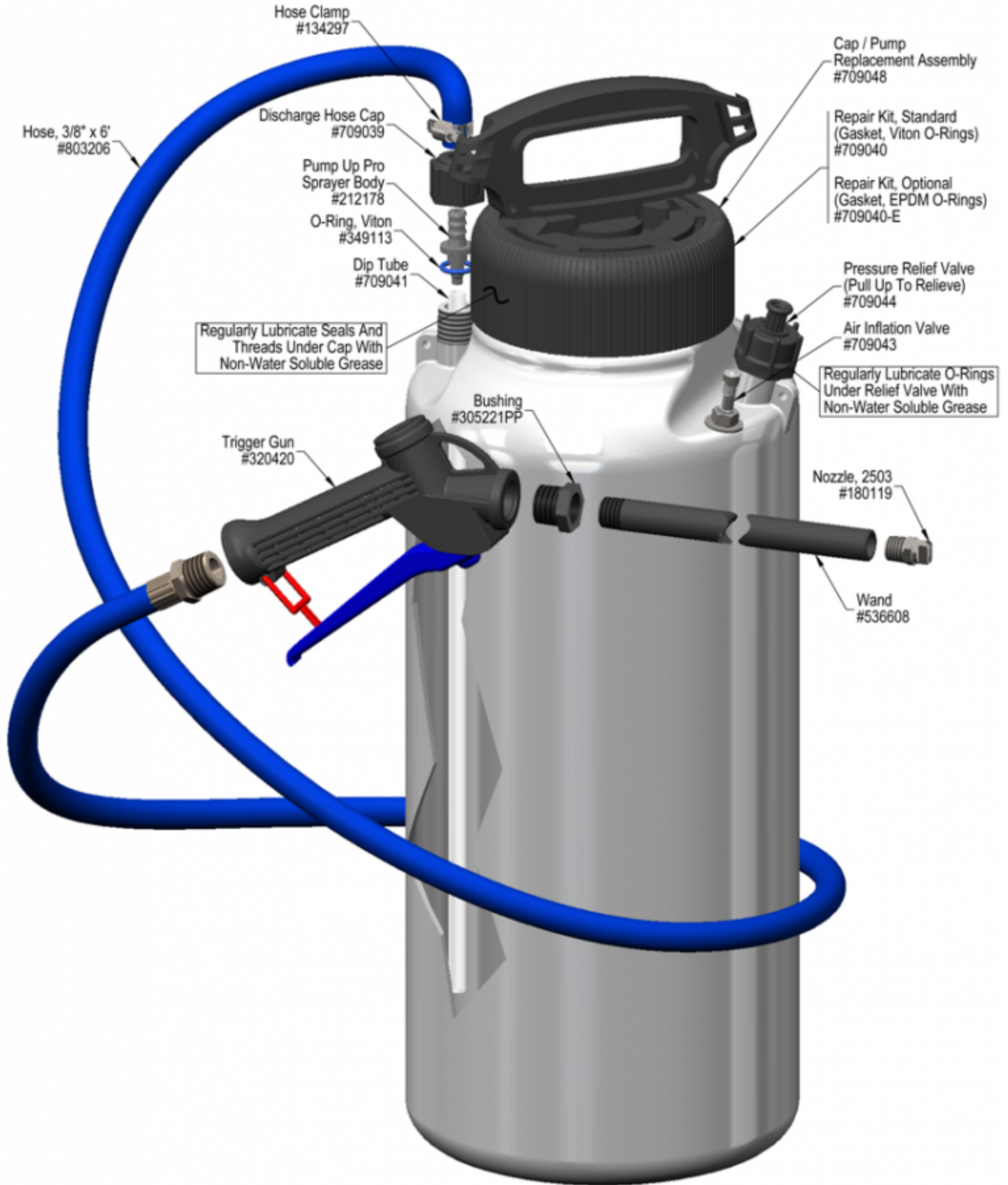

Problem	Possible Cause / Solution	
	Startup	Maintenance
A) Sprayer sputtering	1	2
B) No output / unit will not spray	1	2

Possible Cause / Solution	
Startup	Maintenance
<p>1. Not enough air pressure</p> <ul style="list-style-type: none"> ○ Pump-up sprayer several strokes ○ Less liquid in the tank will allow for more air pressure to build and spray for longer 	<p>2. Air leaks due to loose lid, worn or damaged components/fittings</p> <ul style="list-style-type: none"> ○ Tighten the lid. Lubricate the lid and pressure relief O-rings. Order repair kit and replace damaged O-rings, gaskets, valves etc. ○ Refer to the Pump-Up O-Ring Replacement Guide http://appequip.net/uploads/documents/pump-up-o-ring-replacement.pdf ○ To ensure chemical compatibility with the o-ring seal material, Viton or EPDM replacement kits are available. Viton is standard.

PREVENTIVE MAINTENANCE: * Prior to storage, empty, clean and dry the foamer. * Lubricate O-ring in pressure relief valve and the piston/cylinder with non-water soluble grease (such as petroleum jelly) on a regular basis. * Lubricate tank cap threads and both sides of the gasket with a small amount of non-water soluble grease (such as petroleum jelly) to achieve a tight seal and to ease tightening and loosening.

